

CLOCK SPRING REMOVAL/INSTALLATION

B3E081066123W01

1. Disconnect the negative battery cable.
2. Remove the following parts:
 - (1) Driver-side air bag module (See [DRIVER-SIDE AIR BAG MODULE REMOVAL/INSTALLATION.](#))
 - (2) Steering wheel (See [STEERING WHEEL AND COLUMN REMOVAL/INSTALLATION.](#))
 - (3) Front scuff plate (See [FRONT SCUFF PLATE REMOVAL/INSTALLATION.](#))
 - (4) Front side trim (See [FRONT SIDE TRIM REMOVAL/INSTALLATION.](#))
 - (5) Lower panel (See [LOWER PANEL REMOVAL/INSTALLATION.](#))
 - (6) Column cover (See [COLUMN COVER REMOVAL/INSTALLATION.](#))
3. Remove in the order indicated in the table.

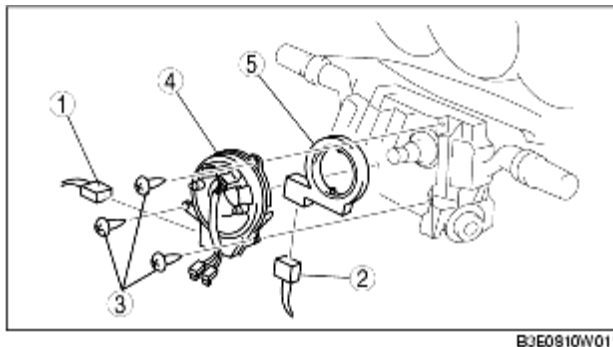

1	Clock spring connector
2	Steering angle sensor connector (with DSC)
3	Screw
4	Clock spring (See Clock Spring Installation Note.)
5	Steering angle sensor (with DSC) (See Steering Angle Sensor Removal Note.)

4. Install in the reverse order of removal.
5. Turn the ignition switch to the ON position.
6. Verify that the air bag system warning light illuminates for **approx. 6 s** and goes out.
 - If the air bag system warning light does not operate normally, refer to the on-board diagnostic system (air bag system) and perform inspection of the system.

Clock Spring Installation Note

Caution

- If the clock spring is not adjusted, the spring wire in the clock spring could over-wind and break when the steering wheel is turned. Always adjust the clock spring after installing it.

1. Adjust the clock spring after installing it. (See [CLOCK SPRING ADJUSTMENT.](#))

Steering Angle Sensor Removal Note

1. Detach the tabs at the four locations shown in the figure and remove the steering angle sensor.

